

SINK LIGHT SCHEMATIC

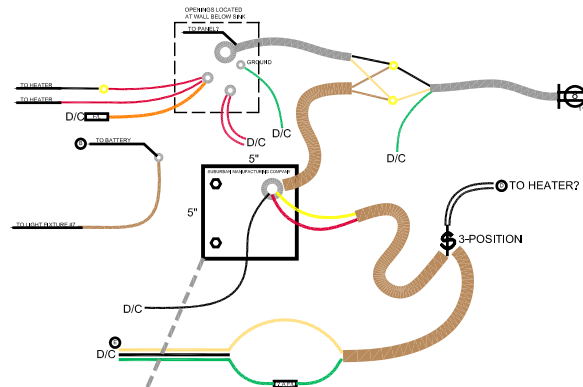

UNDER-SINK MYSTERY

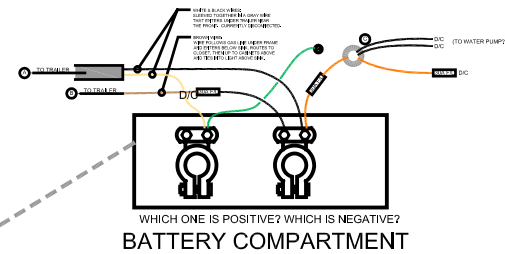

WHICH ONE IS POSITIVE? WHICH IS NEGATIVE?  
BATTERY COMPARTMENT

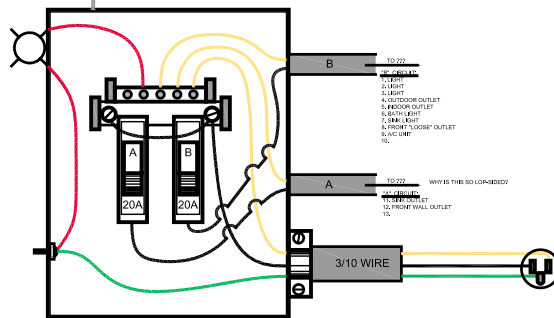
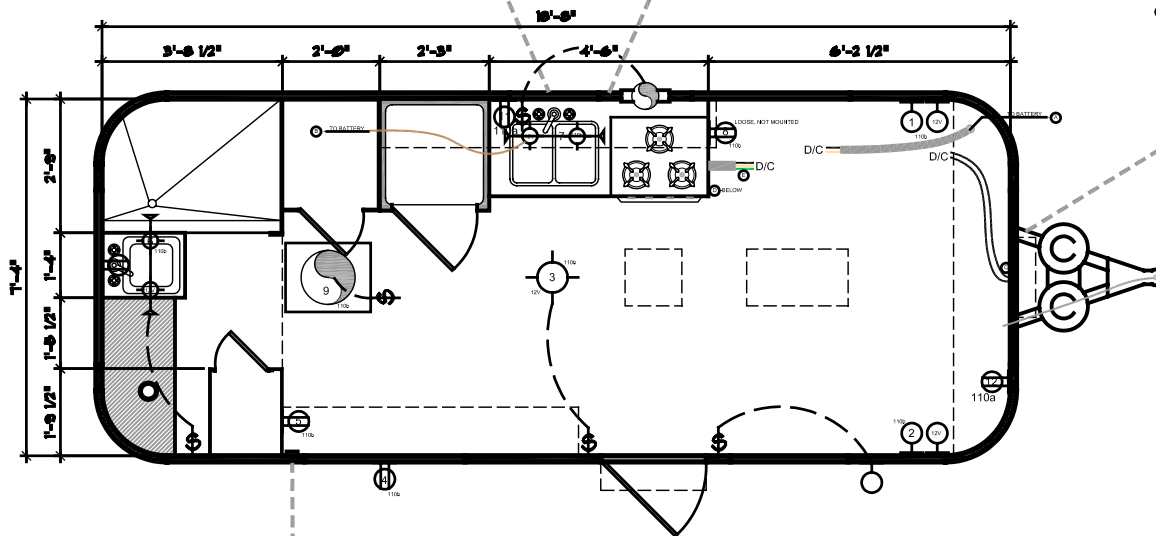

BREAKER PANEL

This is my generic wiring diagram:

1. Breaker Panel
2. Battery Box
3. Under-sink wire nest
4. Above-sink light wiring.

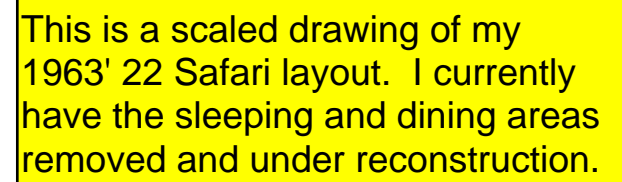

### Questions:

1. Is this light OEM installed? It looked a bit gerry-rigged, so I removed it. If so, what can I replace it with?
2. Which fixtures do the Romex wires usually home run from?
3. Why is circuit "B" so heavily loaded while "A" is relatively empty? Plenty of room for adding to circuit "A"?

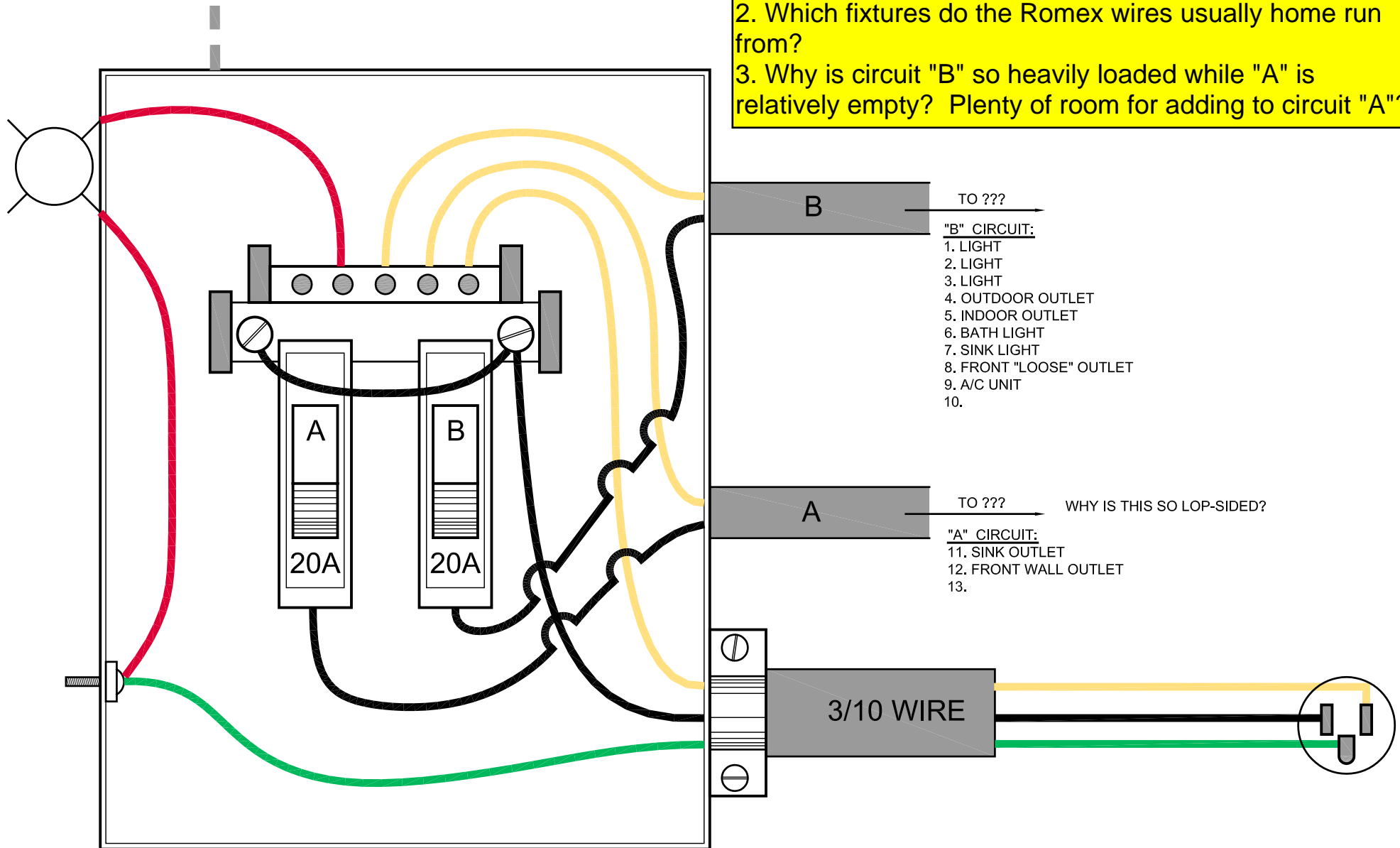



## Questions:

1. Which battery terminal is positive and which is negative?
2. I've noticed most of the fusible-links are 30A, but a few are 20A. Does it make a difference if I make them all 30A?
3. Where/what are the orange wires for? Why would a previous owner have disconnected and removed the components to one of them?
4. Two black loose wires: for the 12V water pump? How do I connect them to the battery?
5. Green wire. Does it typically ground to the aluminum frame? Or is it grounding somewhere inside the frame to an alternate ground? Does aluminum suffice?
6. How is my battery suppose to charge? I have a '63, no Univolt charging system. From all I've read, it's suppose to charge off of the auto battery. How?

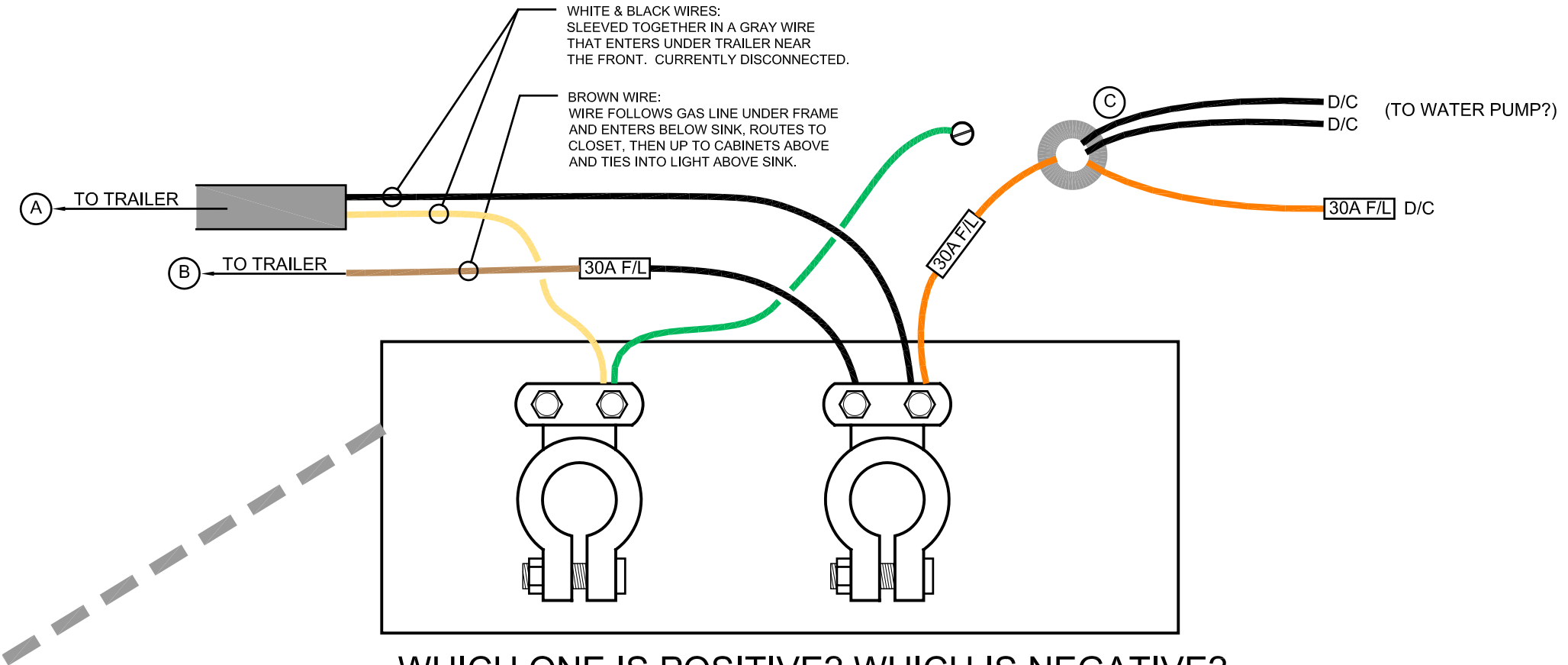

WHICH ONE IS POSITIVE? WHICH IS NEGATIVE?

# BATTERY COMPARTMENT



This is a brand new battery. I'm thinking about picking up a 12V 5W solar charger from BatteryMinder to bypass a charger/inverter system. Anyone have any **NEGATIVE** experience with these particular units?  
P.S. I live in sunny Colorado.



Here is one orange wire, disconnected??

I'm just a dumb architect trying to play electrical engineer. Please email me if this diagram does not make sense. All wires represent the actual color that I noted them to be.

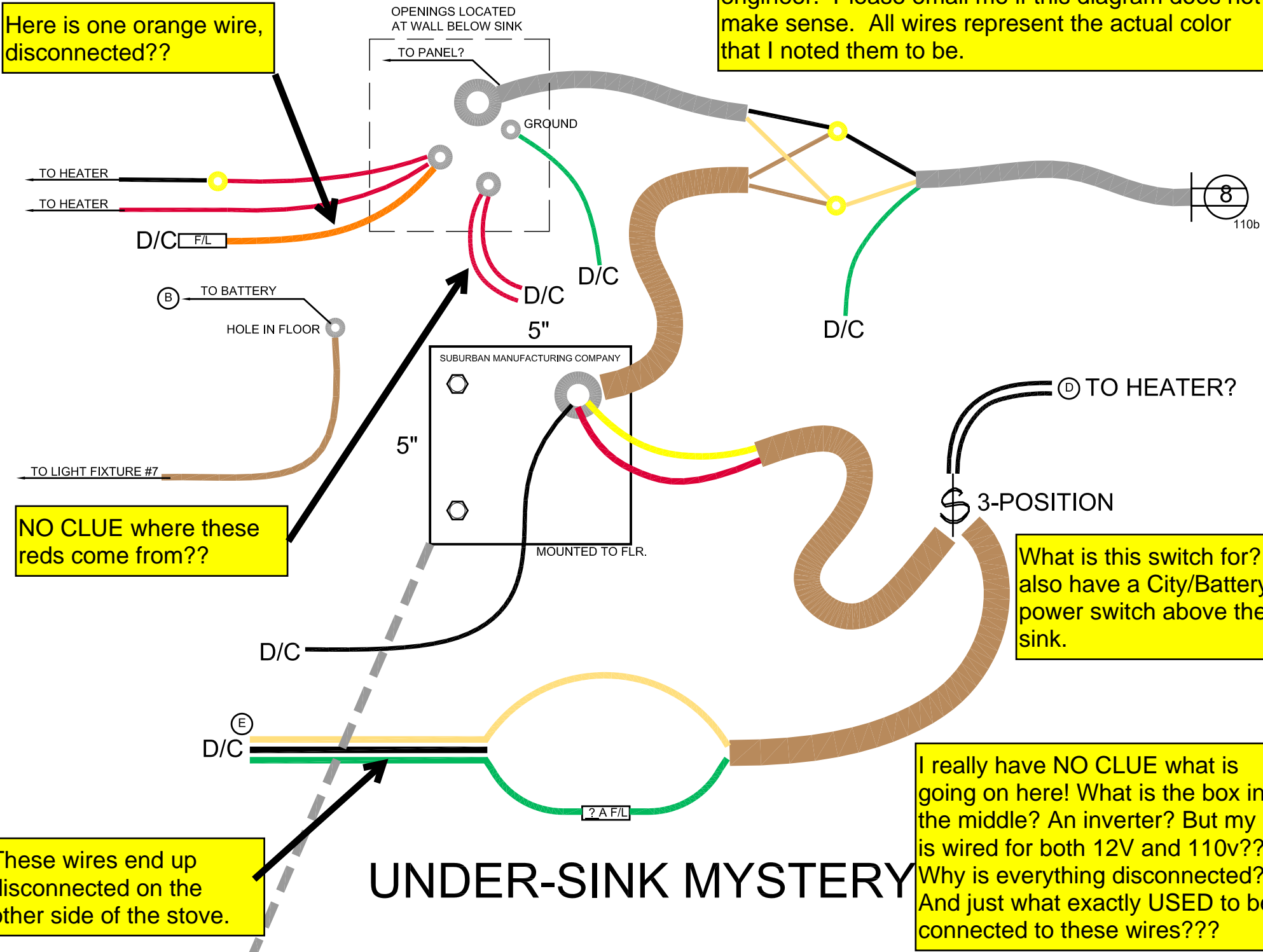

# UNDER-SINK MYSTERY

I really have NO CLUE what is going on here! What is the box in the middle? An inverter? But my '63 is wired for both 12V and 110v?? Why is everything disconnected? And just what exactly USED to be connected to these wires???



The Rat's Nest under my sink. Can someone please tell me what that silver 5"x5"x4"h box is for? And why so many wires come in and out of it and are simply disconnect???





I think I have this one figured out. I think this is where my 25V and 110v services meet and split and carry on in series.

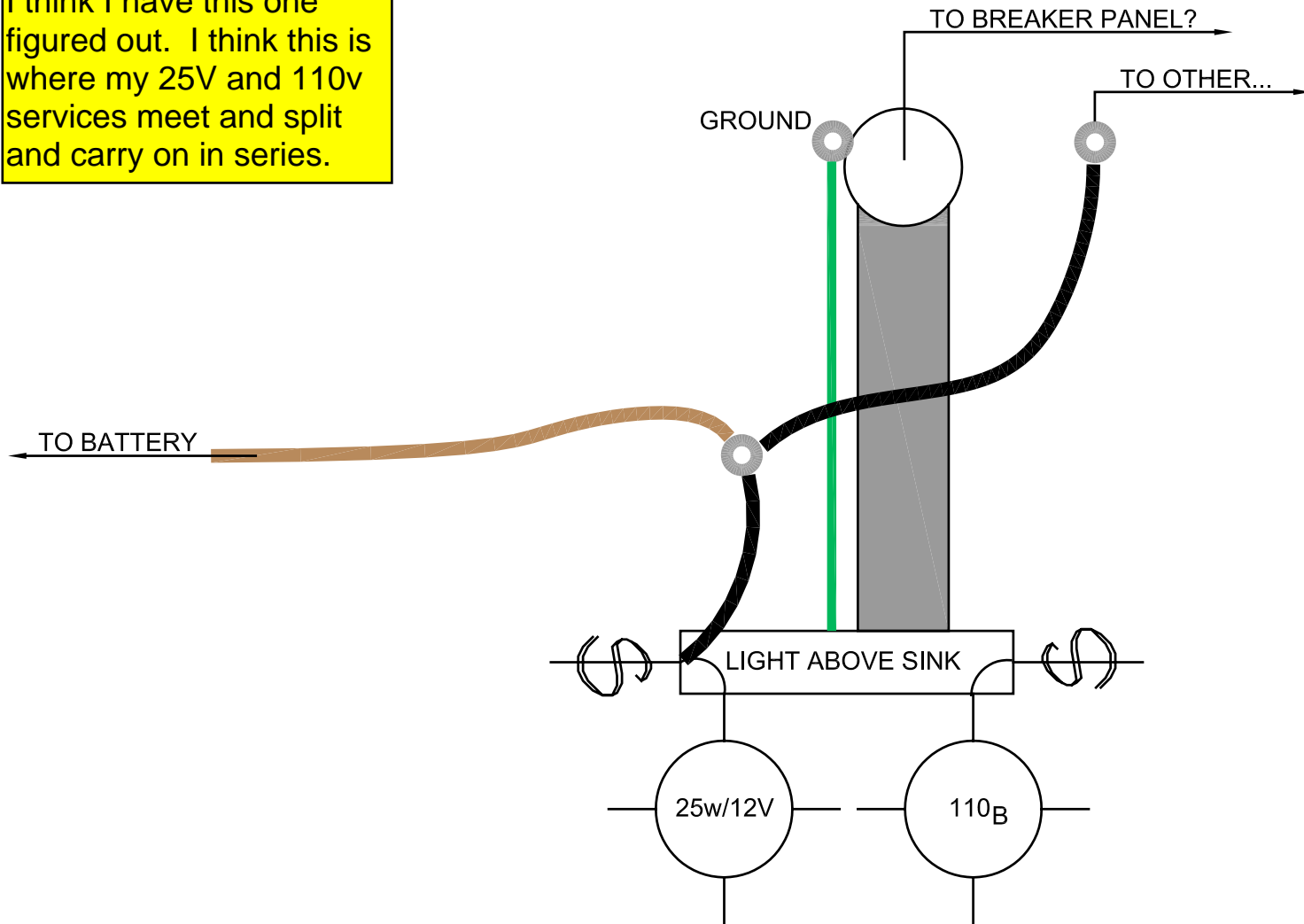

# SINK LIGHT SCHEMATIC

