

MODEL 40

*aqua magic*  
**GALAXY**



MODEL 30

**THE FINEST RECREATIONAL TOILET MADE**  
Features Thetford's Revolutionary New "Micro Rinse" Flushing Principle

### Dual Pedal Water Control

- Fresh Water Rinse
- Proven gas-tight, odor-tight teflon impregnated sealing mechanism
- Modern Styling
- Code Approved
- Highest Quality Standards
- Two Year Warranty
- Lightweight
- Durable High Impact Polyethylene
- Self Cleaning
- Freeze Proof

The Aqua Magic is a fresh water, permanently installed sanitation system. It uses the Micro Rinse flushing principle—which utilizes high velocity water injection, micrometrically measured to produce a "swirl effect" in the bowl, that literally scours the bowl with each flush. With the Micro Rinse principle, the Aqua Magic is so efficient that it will give more

flushes per given holding tank capacity than any other toilet on the market.

A self cleaning, odor-tight, gas-tight, teflon seal closes off the holding tank when the unit is not in use. Since each and every flush uses fresh water, no mandatory chemical additives with their associated schedules are needed.





## SPECIFICATIONS

Material: Polyethylene

Size: See Below

### COMPONENTS DIMENSIONS

MODEL 40

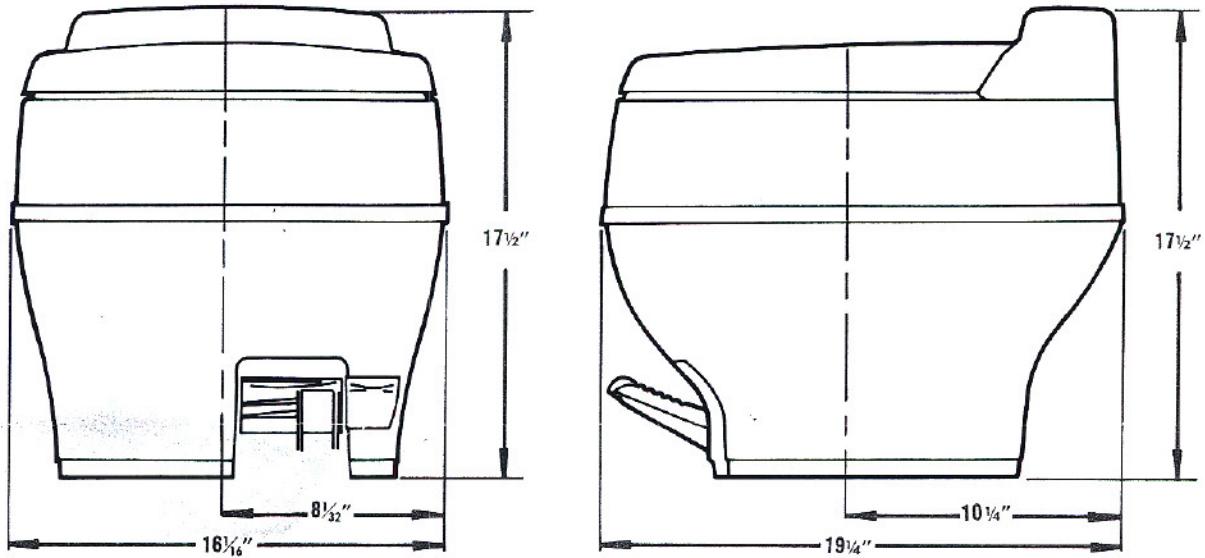

MODEL 30

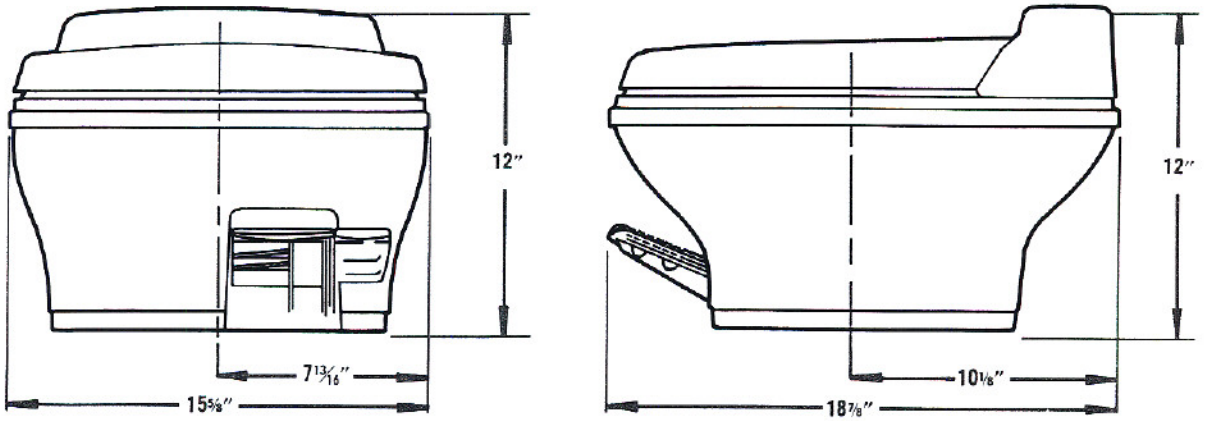

# MODEL 30

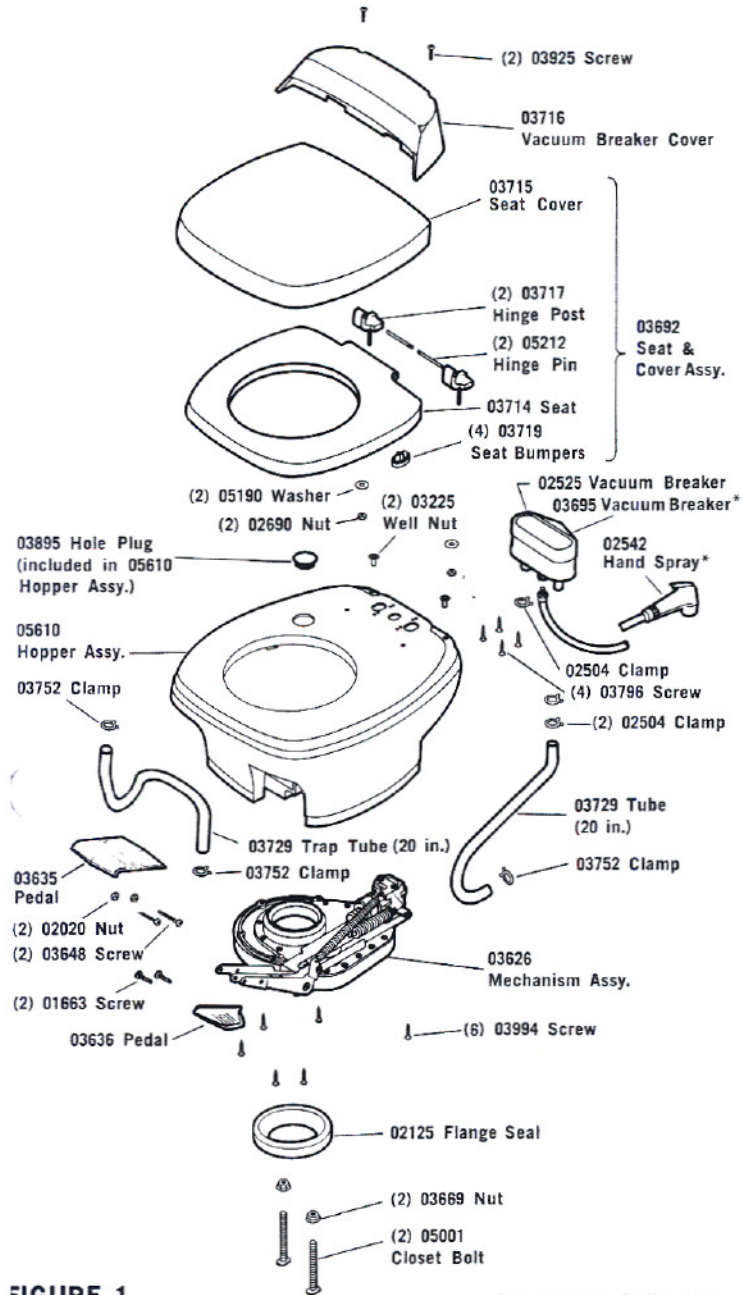

FIGURE 1

\*Water Saver Option Only

# MODEL 40

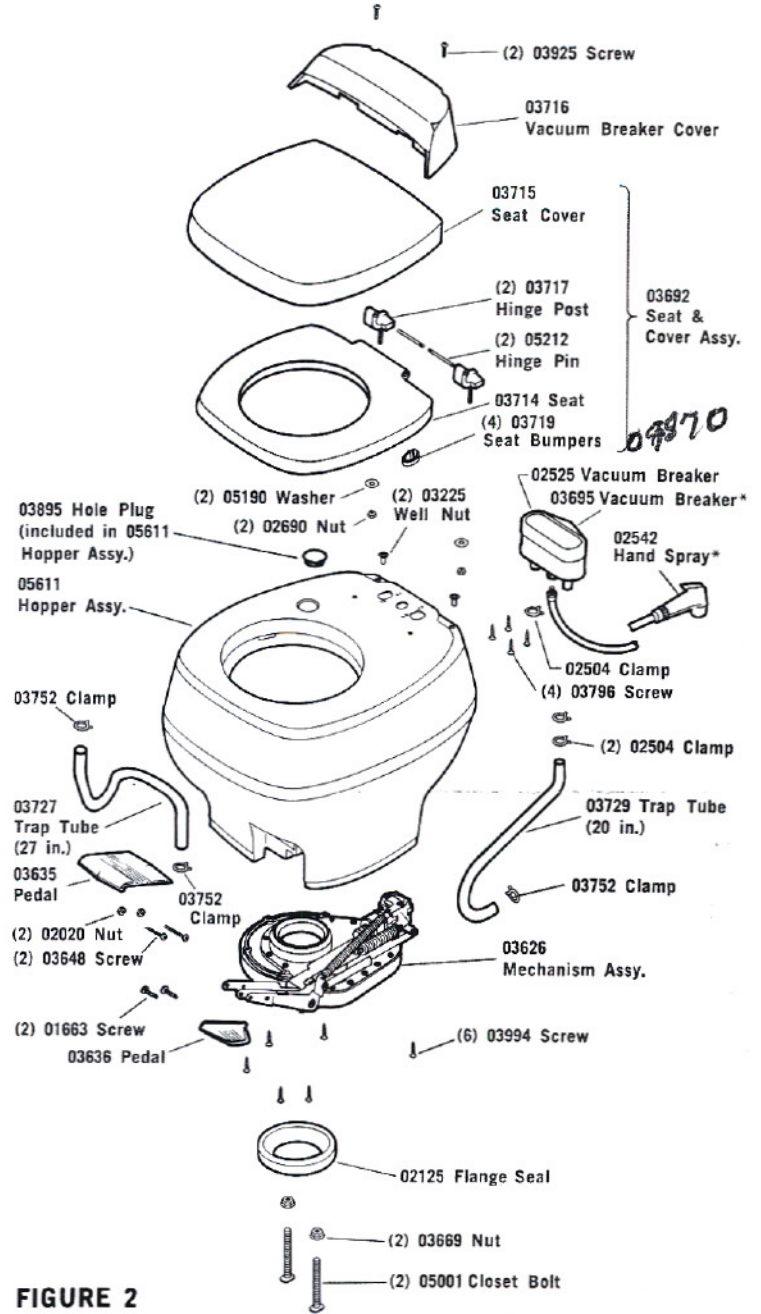

FIGURE 2

\*Water Saver Option Only

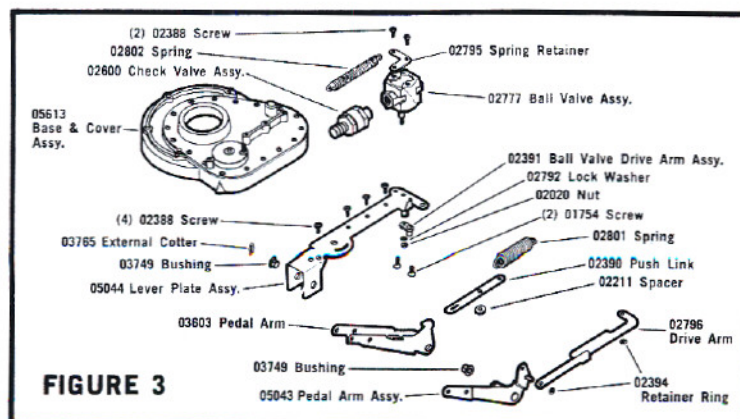

FIGURE 3



## INSTALLATION

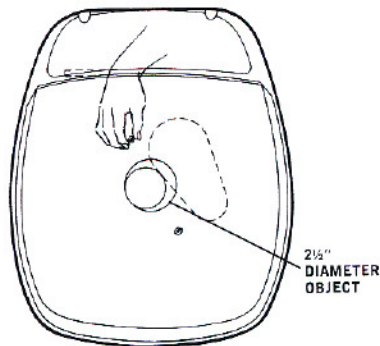

FIGURE 4

1. Closet Flange Seal
  - a. Place closet flange seal over the mechanism ring found on the under side of the toilet.
2. Rear Bolt Nut
  - a. You assemble the rear closet bolt flange nut by reaching with your right hand through the rear access hole (shown in Figure 4). The header points on the closet bolts will help start the nut. Tighten the nut until the base of the toilet contacts the floor.

**Note:** If the space around the toilet does not permit the above method, access to the rear nut can be gained by removing the access plug (shown in Figure 5). Plug is removed by pressing down on the plug's edge closest to the bowl. You assemble the rear closet bolt flange nut by reaching through the access hole with a socket, a universal and a 12" extension. The flange nut may be held in the socket with a small dab of sealer.

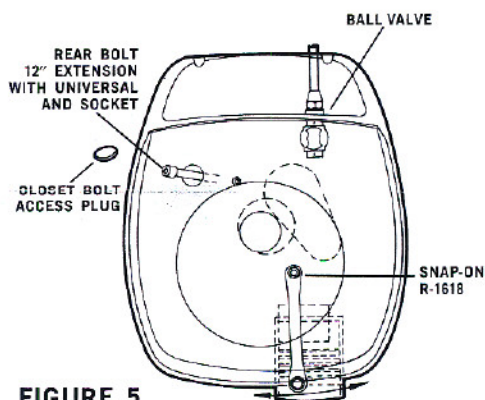

FIGURE 5

3. Front Bolt
  - a. Depress the pedal and insert a round object such as a soft drink bottle into the outlet located at the bottom of the bowl. Release the pedal slowly until the blade touches and holds the object. The object will hold the pedal down and provide access to the front flange bolt.
  - b. Assemble the front flange nut. Tighten nut until the base of the toilet contacts the floor. This stabilizes the toilet installation and provides an odor-tight seal to the closet flange.
4. Water Line Connection
  - a. Water line connections are 3/8"-18 pipe thread. Turn pipe nipple or flare connector until finger-tight plus one turn. Do not overtighten. Do not solder metal fittings while they are connected to the plastic control valve.

## DISASSEMBLY OF THE AQUA MAGIC GALAXY MODELS 30 & 40

### General Information:

The Aqua Magic disassembles into four main subassemblies (see Figures 1 or 2).

1. The seat and cover
2. The vacuum breaker
3. The mechanism
4. The bowl

1. Removal of the seat and cover subassembly.  
Disassemble the vacuum breaker cover by removing the two rear screws. Now, turn the toilet up-side-down. The seat and cover are attached to the bowl with a standard hinge and bolt assembly. Remove the nuts from the hinge bolts and lift the cover and seat from the bowl.

2. Removal of the vacuum breaker subassembly.  
Dissemble the vacuum breaker cover by removing the two rear screws. Turn the toilet up-side-down. To remove water lines from vacuum breaker base, pinch hose clamps with a pair of pliers and slide them up the water line. Water lines may be pulled off. Remove the four vacuum breaker attachment screws.
3. Removal of the mechanism subassembly.  
Turn the toilet up-side-down. Remove the six screws that are now visible. Lift up mechanism to gain access to water line hose clamps. Pinch hose clamps with a pair of pliers and slide them up the water line. Pull water lines off of mechanism. See Figure 3 for available service parts.
4. Service and replacement of bowl subassembly.  
Bowl subassembly may be serviced or replaced by removing the above 3 subassemblies.



## OPERATING INSTRUCTIONS

### 1. Directions for automatic flush and refill.

Depress the foot pedal until the Micro Rinse completely cleanses the bowl, then release.

### 2. Directions for water control pedal.

If you wish to add water into the bowl without flushing, depress the small, right hand pedal until desired water level is reached, then release.

## MAINTENANCE

No routine maintenance is required.

If the bowl sealing blade does not operate freely after extended use, it may be restored to its original, smooth operating condition by applying a light film of Silicone spray to the blade.

To clean the Aqua Magic, use Thetford Aqua Bowl or any other high grade, non-abrasive cleaner. Do not use highly concentrated or high acid content household cleaners. They may damage the rubber seals.

## WINTERIZING

### 1. By Draining

Completely drain the toilet water supply line. Leave any water supply line valves open. Depress foot pedal and insert a round object such as a soft drink bottle into the outlet located at the bottom of the bowl. Release the foot pedal slowly until the blade touches and holds the

object. This will hold the water control valve open and prevent any residue water from being trapped there when frozen.

### 2. By non-toxic Anti-Freeze

Use Thetford Aqua Thaw Recreational Anti-Freeze. Follow directions on the container.

## TROUBLE-SHOOTING

### 1. Symptom:

Water keeps running into the bowl.

#### Cause:

The blade in the bottom of the bowl is not closing completely, which in turn keeps the water control valve partially open. The groove into which the blade seats when completely closed is clogged with foreign material.

#### Cure:

Insert the end of a coat hanger or similar object into the sealing groove and remove the foreign material. Avoid damaging the rubber seal while cleaning.

### 2. Symptom:

Toilet leaks. There is water on the floor.

Specify the symptom. Determine if water is leaking from:

- The vacuum breaker
- The water control valve
- Bowl to mechanism seal (if this is the problem, the water would not stay in the bowl).

d. Closet flange base seal.

#### Cure:

- The vacuum breaker—if the vacuum breaker leaks when flushing the toilet, replace the vacuum breaker.
- If the vacuum breaker leaks when the toilet is not in operation, replace the water control valve.
- Leaks at the bowl to mechanism seal—remove mechanism, and replace mechanism seal.
- Leaks at closet flange area—check front and rear closet flange nuts for tightness. If leak continues remove the toilet, check the close flange height. The height should be between 1/4" and 7/16" above the floor. Adjust closet flange height accordingly and replace closet flange seal.

### 3. Symptom:

Foot pedal operates harder than normal or the blade sticks.

#### Cure:

Apply a light film of Silicone spray to blade.

03895 Ho  
(included  
Hopper

05610  
Hopper

03752 Cl:

03635  
Pedal

(2) 02020  
(2) 03648

(2) 01663

03

FIGUR