

**USA**

SERVICE OFFICE
Dometic, LLC
2320 Industrial Parkway
Elkhart, IN 46516
574-294-2511

CANADA

Dometic, LLC
46 Zatonski, Unit 3
Brantford, ON N3T 5L8
CANADA
519-720-9578

**For Service Center
Assistance Call:**
800-544-4881

**3107688.016 AUXILIARY
DRAIN PAN KIT****SERVICE INSTRUCTIONS****MODEL
3107688.016****REVISION**

Form No. 3107804.027 4/12
(Replaces 3107804.019)
(French 3109600.019)
©2012 Dometic, LLC
LaGrange, IN 46761

**Read these instructions carefully. These
instructions MUST stay with this product.**

INTRODUCTION

This kit designed for and may only be installed on (Dometic) Penguin, Brisk Air, and High Performance series air conditioners/heat pumps (hereinafter referred to as “unit,” or “product”) only. Installation must take place prior to installing the unit. Use the following procedure to ensure a properly installed, and properly functioning unit. Dometic, LLC reserves the right to modify appearances and specifications without notice.

TABLE OF CONTENTS

INTRODUCTION	2
DOCUMENT SYMBOLS	2
GENERAL INFORMATION.....	2
A. Scope Of Delivery.....	2
B. Required Tools.....	2
PROCEDURE.....	3
A. Penguin Unit.....	3
B. Brisk Air Unit.....	4
C. High Performance Unit	5

DOCUMENT SYMBOLS



Indicates additional information that is **NOT** related to physical injury.



Indicates step-by-step instructions.

GENERAL INFORMATION

A. Scope Of Delivery

1. Service Instructions
2. (1) Auxiliary Drain Pan Assembly
3. (4) Screw, D 10-16 x .75" PHCR
4. (1) Gasket, Roof 14" x 14" x 3/4"
5. (1) Gasket, Roof 16" x 1.5" x 3/4"
6. (1) Gasket, Roof 10" x 1.5" x 3/4"

B. Required Tools

- Electric Drill
- #2 Phillips Screw Drive Bit
- Hose Clamp Pliers (Flat Band)
- Utility Knife
- Hose Shears (or Utility Knife)
- Measuring Tape
- All Weather Sealant

PROCEDURE

A. Penguin Unit

1. Place unit upside-down on a clean work surface. Be careful not to slide unit on its top to avoid damage to shroud.
2. Cut out a 3/4" section of roof gasket, on both sides down to the base pan, to route the drain pan hose through. Measure in from the front edge of gasket 6-1/2". See (FIG. 1).

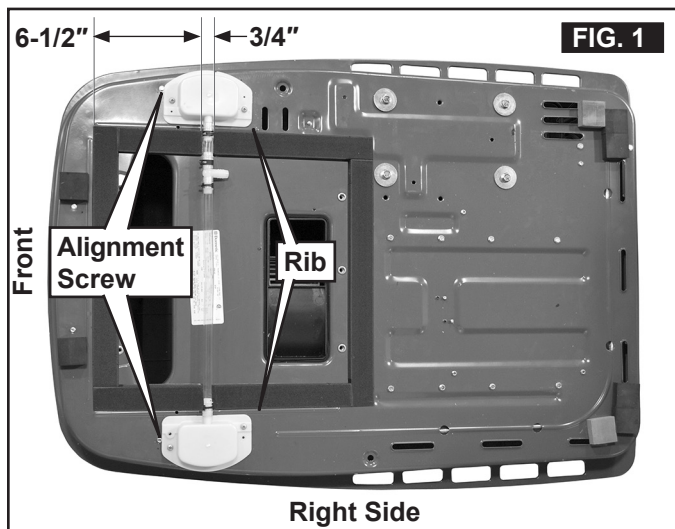

3. Align the drain pans using the screw and rib in the base pan as a guide. Long straight edge of drain pan runs along and parallel to the rib. See (FIG. 1).
4. Using the self-drilling screws provided, attach the drain pans to the base pan. See (FIG. 2) for screw location.

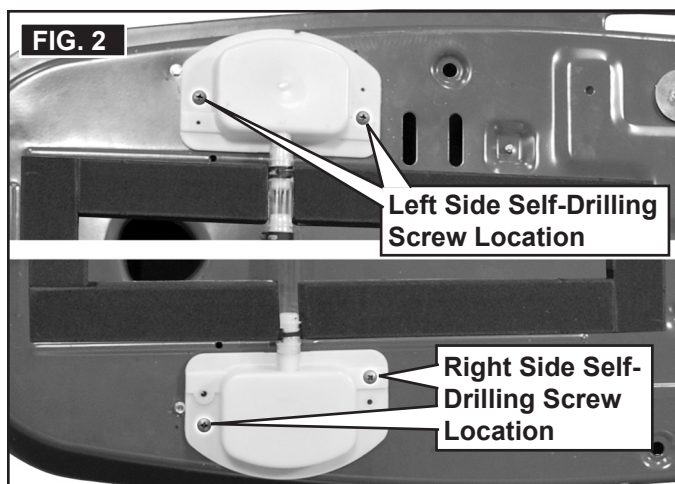

i If drain tube does **NOT** lay flat and straight between the two drain pans, trim hose on side opposite drain outlet as needed to allow it to lay flat and straight.

5. Seal below and above each drain tube where it goes through the roof gasket with a good all weather sealant. Do **NOT** seal edges of drain pan to base pan. When left unsealed this will act as a secondary drain in the event the primary drain becomes clogged.
6. Adhere the supplied square roof gasket to the existing one. See (FIG. 3).

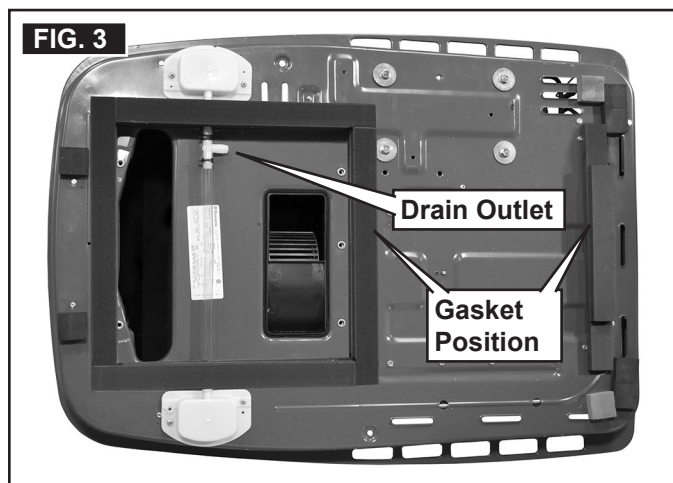

7. Adhere the 16" supplied gasket to the base pan as shown in (FIG. 3).
8. Adhere the 10" supplied gasket to the 16" gasket as shown in (FIG. 3).

i Auxiliary drain pan kit installation is now complete. Turn unit right-side up and install it in the normal manner per unit installation instructions.

Since the unit now has double gaskets, the installed compressed measurement indicated in the unit Installation Instructions of 3/4" does **NOT** apply.

Connect 1/2" I.D. hose to drain outlet and route through the roof opening frame and to outside of RV in installer preferred manner. For best draining, keep hose flat. Do **NOT** allow it to hump up.

PROCEDURE

B. Brisk Air Unit

1. Place unit upside-down on a clean work surface. Be careful not to slide unit on its top to avoid damage to shroud.
2. Cut out a 3/4" section of roof gasket, on both sides down to the base pan, to route the drain pan hose through. On the right side measure in from the front edge of gasket 6-3/8". See (FIG. 4). On the left side measure in from the front edge of gasket 7-1/2". See (FIG. 4).

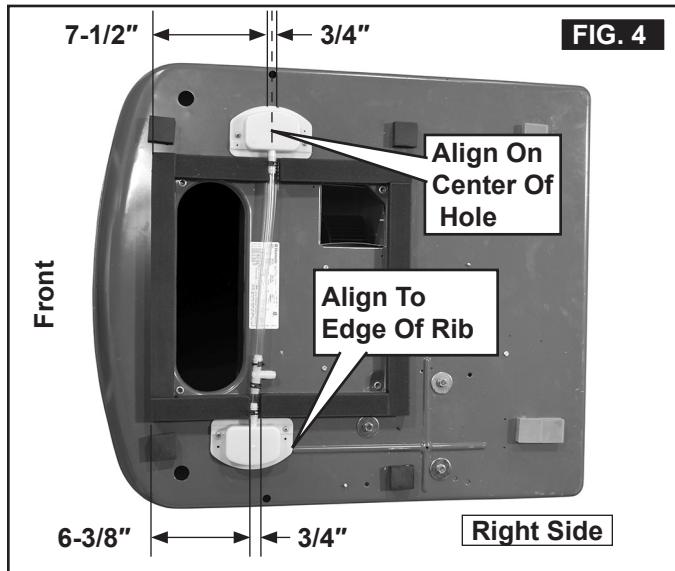

3. To avoid drain hose interfering with air discharge duct, rotate drain outlet 180°.
4. Align right side drain pan to edge of rib and tight against the roof gasket. See (FIG. 4).
5. Align left side drain pan centered on hole in base pan and tight against the roof gasket. See (FIG. 4).
6. Using the self-drilling screws provided, attach the drain pans to the base pan. See (FIG. 5) for screw location.

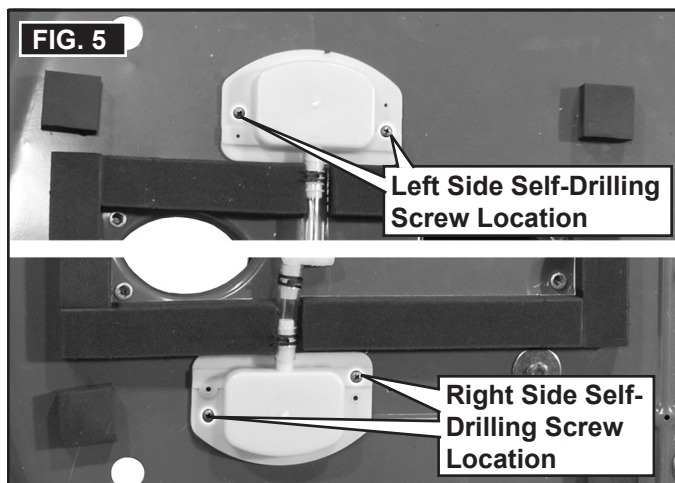

i If drain tube does **NOT** lay flat and straight between the two drain pans, trim hose on side opposite drain outlet as needed to allow it to lay flat and straight.

7. Seal below and above each drain tube where it goes through the roof gasket with a good all weather sealant. Do **NOT** seal edges of drain pan to base pan. When left unsealed this will act as a secondary drain in the event the primary drain becomes clogged.
8. Adhere the supplied square roof gasket to the existing one. See (FIG. 6).

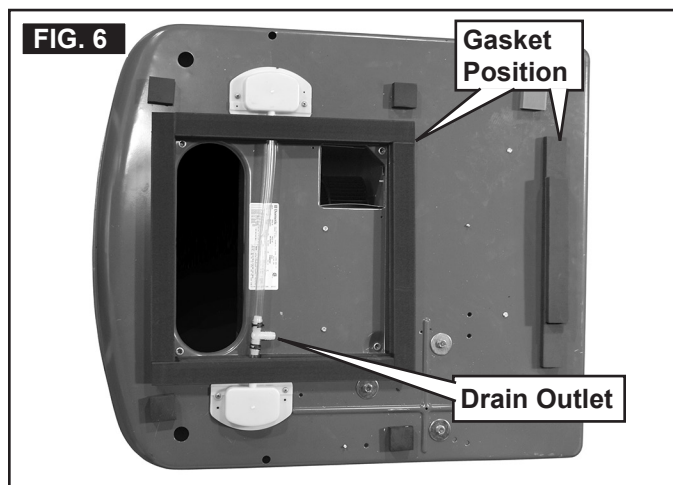

9. Adhere the 16" supplied gasket to the base pan as shown in (FIG. 6).
10. Adhere the 10" supplied gasket to the 16" gasket as shown in (FIG. 6).

i Auxiliary drain pan kit installation is now complete. Turn unit right-side up and install it in the normal manner per unit installation instructions.

Since the unit now has double gaskets, the installed compressed measurement indicated in the unit Installation Instructions of 3/4" does **NOT** apply.

Connect 1/2" I.D. hose to drain outlet and route through the roof opening frame and to outside of RV in installer preferred manner. For best draining, keep hose flat. Do **NOT** allow it to hump up.

PROCEDURE

C. High Performance Unit

1. Place unit upside-down on a clean work surface. Be careful not to slide unit on its top to avoid damage to shroud.
2. Cut out a 3/4" section of roof gasket, on both sides down to the base pan, to route the drain pan hose through. Measure in from the front edge of gasket 8-1/4". See (FIG. 7).

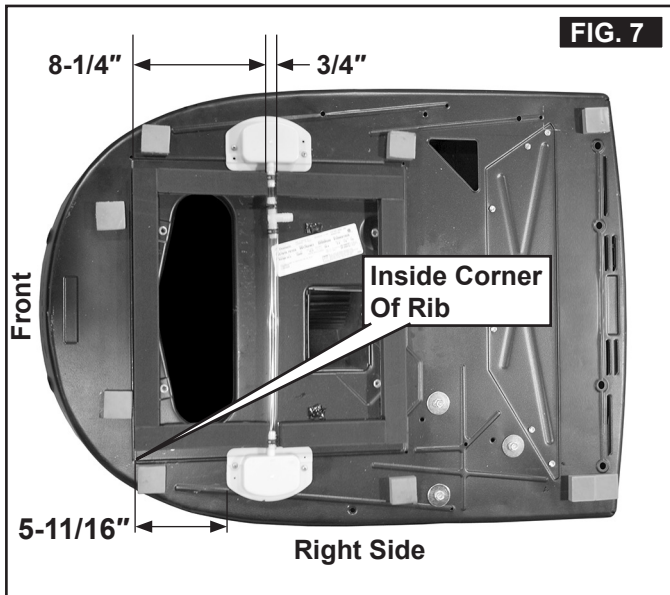

3. Align drip tray 5-11/16" from inside corner of base pan rib and tight against the roof gasket. See (FIG. 7).
4. Using the self-drilling screws provided, attach the drain pans to the base pan. See (FIG. 8) for screw location.

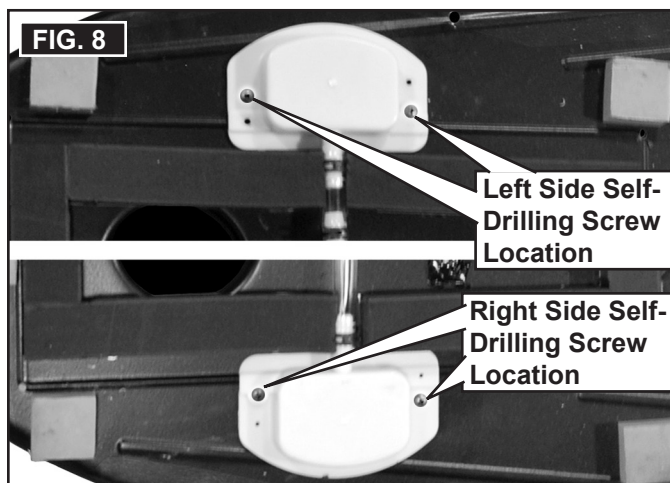

i If drain tube does **NOT** lay flat and straight between the two drain pans, trim hose on side opposite drain outlet as needed to allow it to lay flat and straight.

5. Seal below and above each drain tube where it goes through the roof gasket with a good all weather sealant. Do **NOT** seal edges of drain pan to base pan. When left unsealed this will act as a secondary drain in the event the primary drain becomes clogged.
6. Adhere the supplied square roof gasket to the existing one. See (FIG. 9).

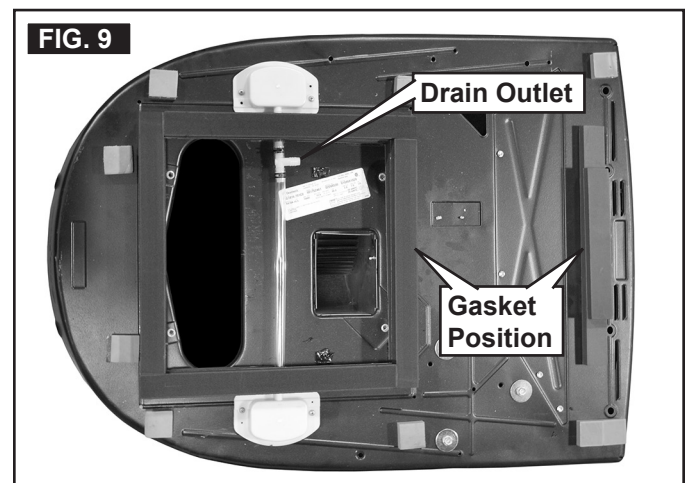

7. Adhere the 16" supplied gasket to the base pan as shown in (FIG. 9).
8. Adhere the 10" supplied gasket to the 16" gasket as shown in (FIG. 9).

i Auxiliary drain pan kit installation is now complete. Turn unit right-side up and install it in the normal manner per unit installation instructions.

Since the unit now has double gaskets, the installed compressed measurement indicated in the unit Installation Instructions of 3/4" does **NOT** apply.

Connect 1/2" I.D. hose to drain outlet and route through the roof opening frame and to outside of RV in installer preferred manner. For best draining, keep hose flat. Do **NOT** allow it to hump up.